

GUIDE

The current guide demonstrates the operation of version number 1.6.0. The geolocation opening feature is currently in a testing phase, which means its functionality may exhibit occasional inaccuracies or inconsistencies, and the accompanying texts are subject to potential modifications. Please use the below function with this in consideration. We welcome your suggestions and comments at technicalsupport@tell.hu. Thank you for your support in contributing to our efforts!

The geolocation opening feature enables the automatic opening of gates when the user arrives at a specified geolocation area, that is, a pre-set physical location identified by the user's mobile device based on GPS data.



Before You Start...

- **Set up** the geolocation opening feature **separately for each gate**.
- **Configuration needs to be performed individually within each mobile application**, because, in compliance with GDPR, data storage occurs on the phone.
- **Always enable location services for the application**. If disabled, the automatic opening function will not operate correctly.

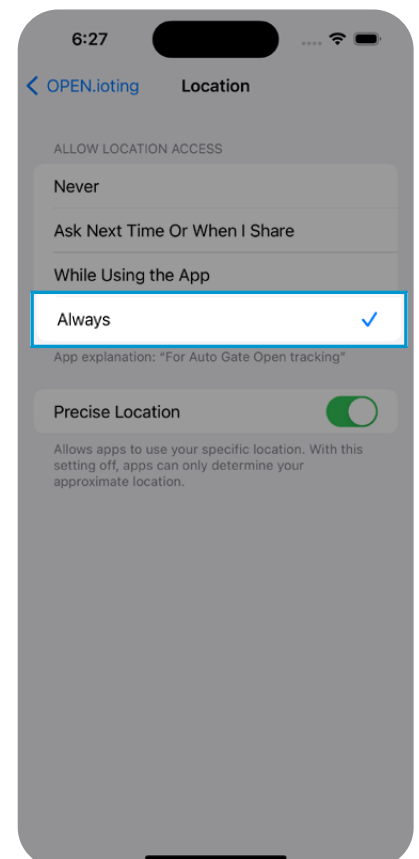
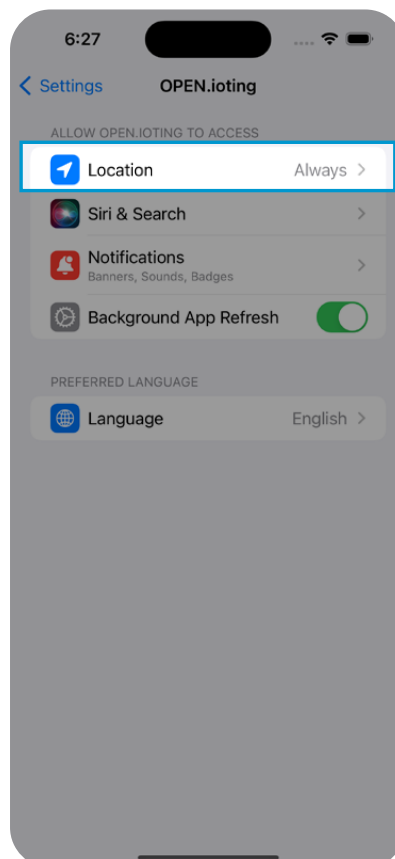
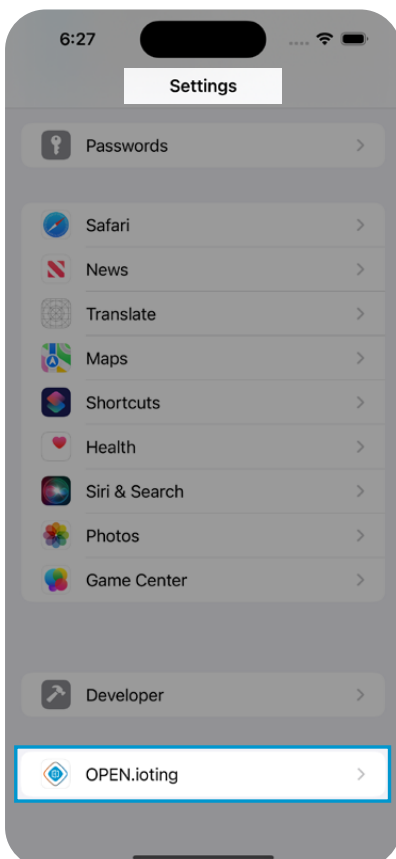

Setting up the Geolocation Opening Feature

- Navigate to the 'Device setup' menu.
- Tap on the '**Geolocation-based Opening (BETA)**' button.
- **Enable the 'Enable opening' button.** This will activate the feature for use.
- The Setup Wizard automatically starts upon first use. The wizard will inform you and guide you through the configurations.

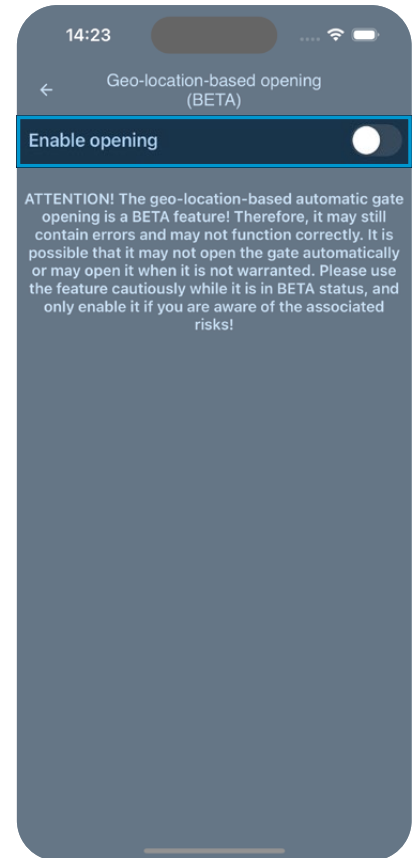

Introduction to the Setup Wizard

Setting up the Area

- Enter the size of the area centered around your gate. We recommend 1000 meters as a default setting.
- The exact location is indicated by the center of cross-hair, which can be specified by zooming and moving the map.

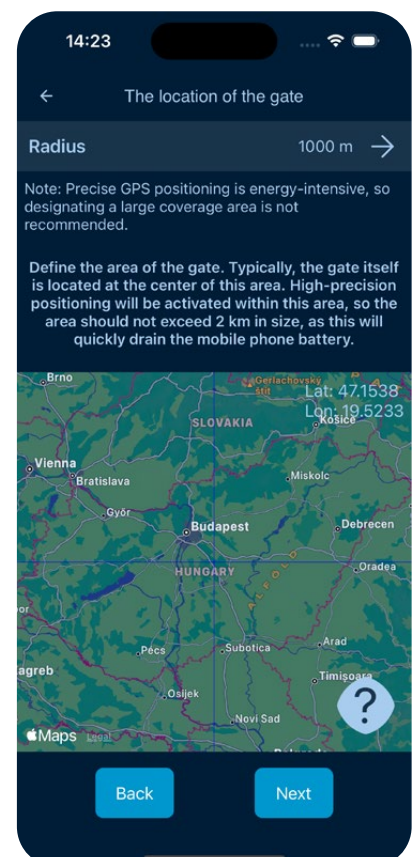

Editing Entry Point (IN point)

Specify the first area (a circular zone) which must be traversed first to trigger the start of the process. Touching this point does not cause automatic opening; that will only occur upon touching the second point (activation point).

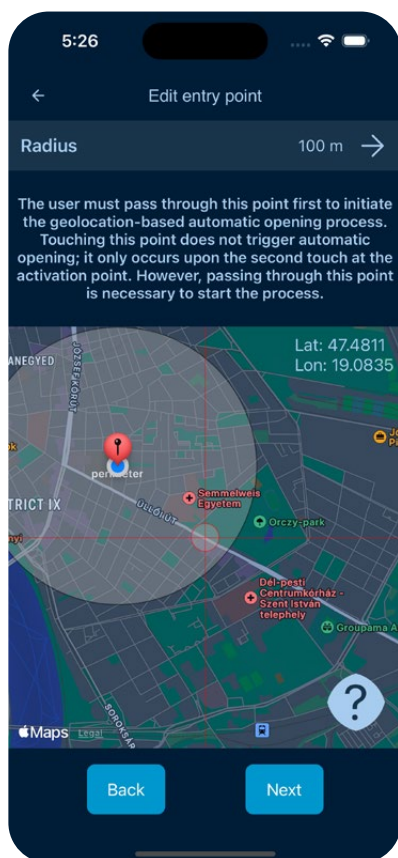

Editing Activation Point (OUT point)

Specify the second area (a circular zone) that must be crossed to initiate the automatic opening process.

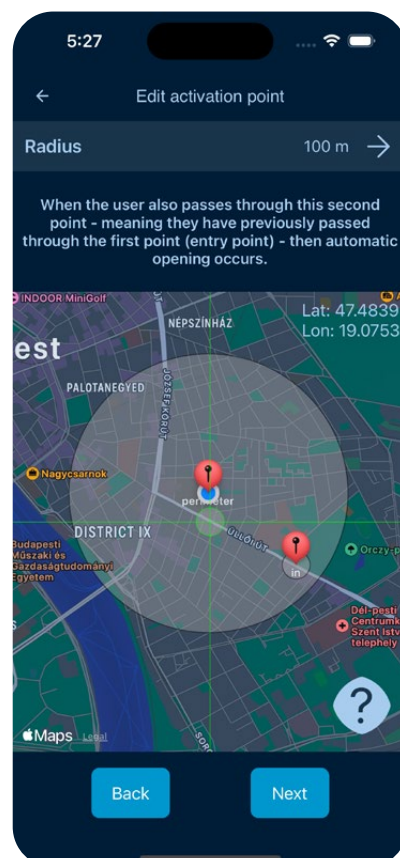

Important! The entry and activation points must not overlap! This requirement is essential to determine the direction of physical movement. Moreover, the gate will only automatically open if you pass through the entry point followed by the activation point. The process does not work in reverse!

After adding the geolocation points, you will return to the 'Geolocation opening (BETA)' menu item.

- Under 'Detection point pairs,' a menu named 'Wizard pair' appears. Here, you can find the geolocation points set earlier. By clicking on the name, you can change the name of the point pair (e.g., from 'Wizard pair' to 'Home') and modify the entry and activation points again.
- In the 'Maximum passage time' menu, enter the time interval (in seconds) during which, if the activation point (OUT) is not reached, the automatic opening will not be activated.
- In the application, under the 'Detection point pairs / New detection point pair' menu item, you can add additional geolocation points.

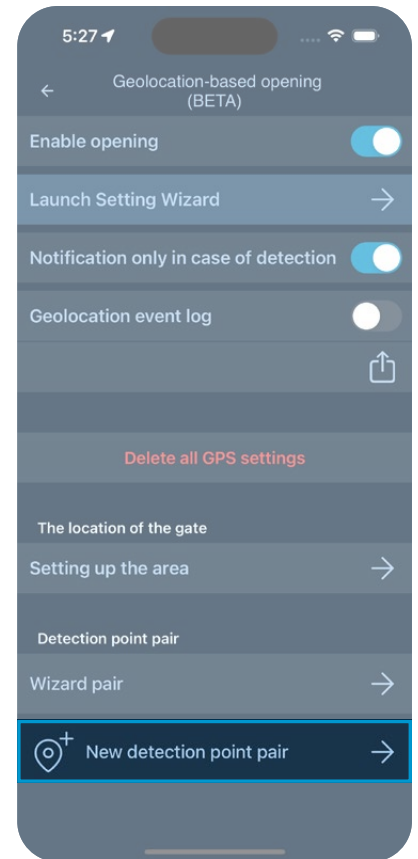
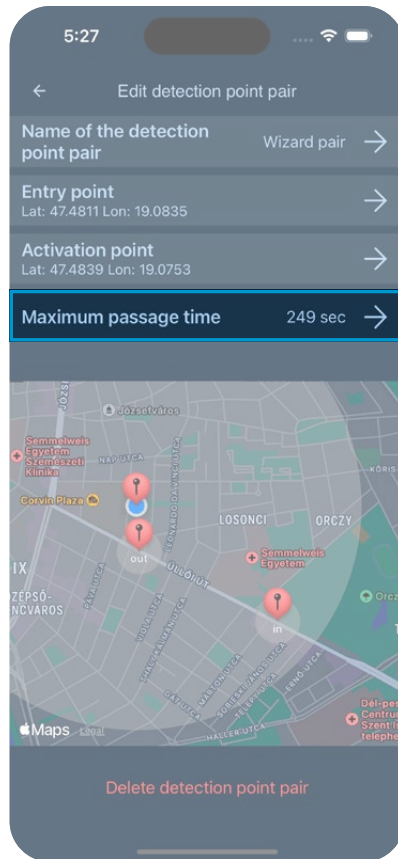
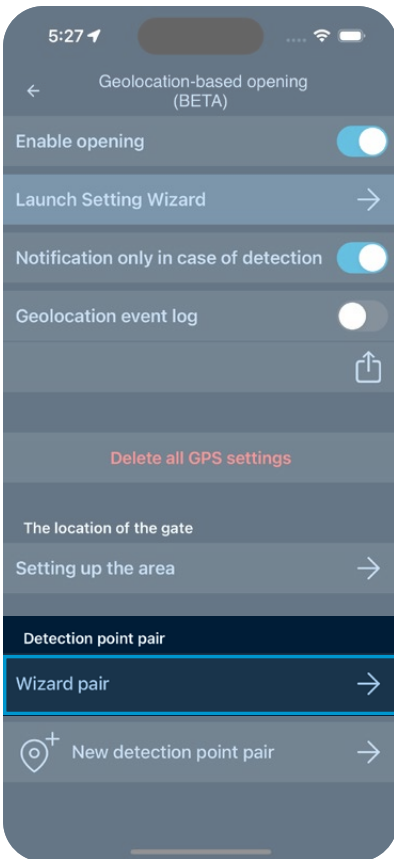

Important! Set up one point pair for each route, as two identical point pairs will 'cancel' each other out.



'Notification only in case of detection' Menu Item

- Enable it if you do not want the geolocation opening to happen automatically.** When you enter the specified geolocation area, a push notification appears, allowing you to authorize or reject the automatic opening.

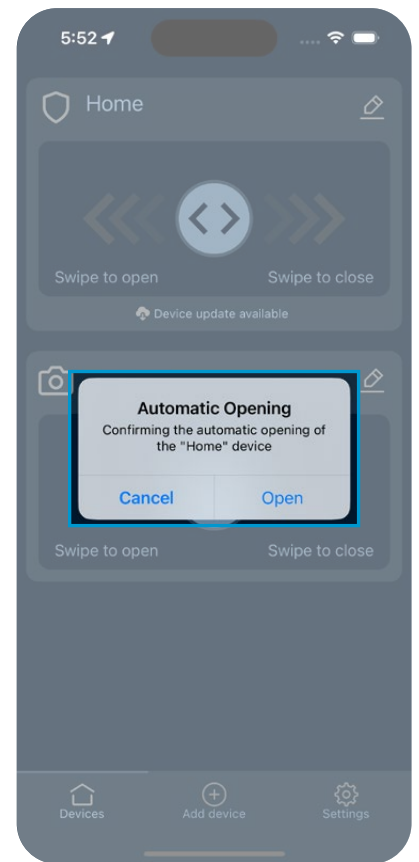
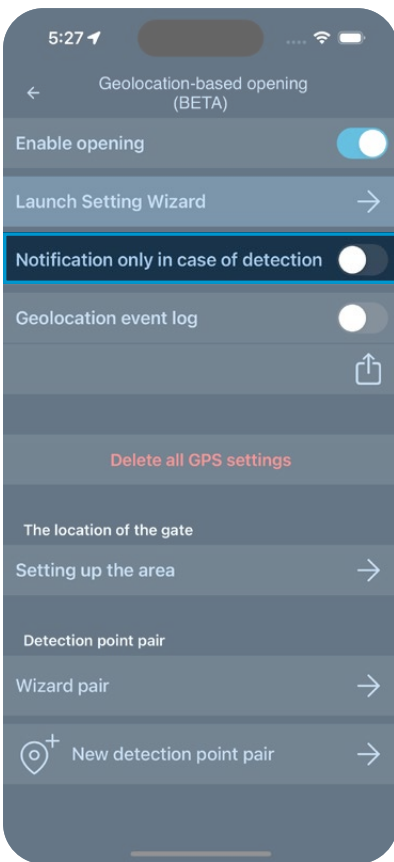

- **Do not enable it (leave it as the default setting) if you want the gate to open automatically.** In this case, by clicking on the 'Open command delay' button below, **specify the time interval** during which you can interrupt the automatic opening of the gate.

